

Fiat Seat Occupancy Mat Emulator Installation

Thank you for choosing SRSDRIVE

This seat mat sensor bypass is compatible with Fiat cars and is created to simulate the passenger in the seat. When seat Mat fails, it fails 9 out of 10 times, then the airbag warning light comes on a dashboard or iDrive. This emulator will bypass the faulty Seat mat Sensor and completely simulates a passenger in the seat and after the error reset, reactivates the airbag system.

NOTE: After installation if light is still ON then reset it with proper diagnostics software.

NOTE: When installed DO NOT PLACE the child seat in front passenger seat!

SRSDRIVE
26 Oakfield Close
Buncrana
Co. Donegal
F93 E4P8
Ireland

Contact us by eBay or email:
sales@srsdrive.com

Sales & customer support hours:
Monday - Friday 9.00 – 17.00
Saturdays 10.00 – 2.00
+44(0)7783725020 +353(0)83847887

For Seat Mat Emulators visit: www.srsdrive.com
For TPMS-Tyre Sensors Bypass: www.tpmsbypass.com



Fiat Stilo Seat Mat Emulator Installation Steps

NOTE: It is strongly recommended to do the car Diagnostics, to make sure that the Seat Occupancy MAT Sensor is Faulty

Make sure to follow INSTALLATION INSTRUCTIONS from point 1 to 5

1. **NOTE:** Before continuing, make sure the ignition is OFF!
2. Check from the front or rear under the passenger seat and locate grey colour connector with 3 wires - red, white, brown as in picture below.

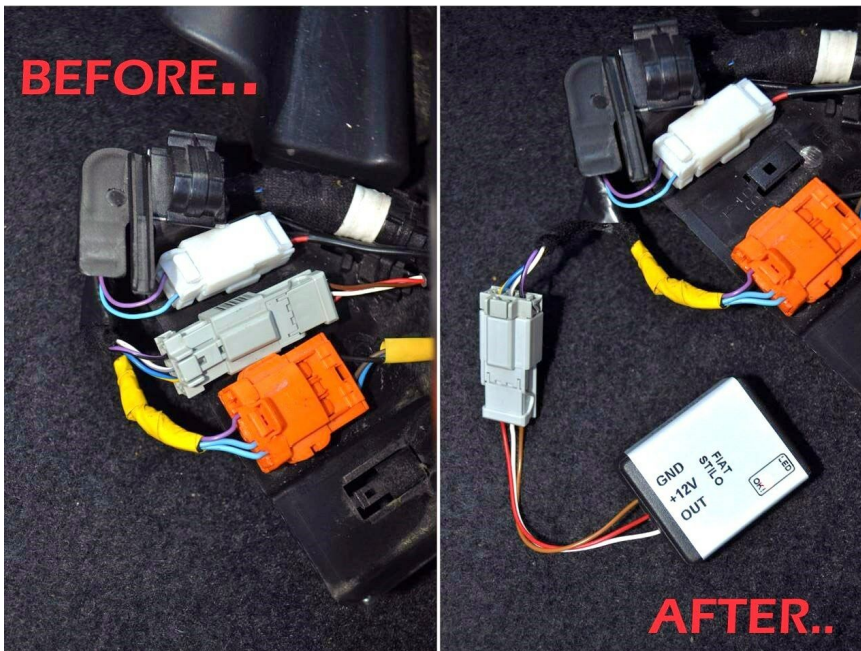

3. Make sure that 3 dip switches on our Emulator are set: 1 OFF, 2 OFF, 3 ON.
4. Unplug this connector and connect Seat Mat Emulator. When it's connected make sure that LED light on emulator is ON/Illuminated. Place the Emulator somewhere safely under the seat.
5. Turn on the ignition and the airbag lights in most cases should reset by itself. If not, bring your vehicle to the garage to reset it with proper diagnostics.

NOTICE

FEEDBACK: It's our aim to give you a 5 Star service and 5 Star quality product, so we encourage that you leave Detailed Seller Ratings with your Feedback to reflect this, only then we'll be able to continue to provide the best possible service and prices to you, our customers. Would be highly appreciated if you rate the seller on the time it took to dispatch your order, not the time it took you to receive it. And you are welcome to exchange positive feedbacks here on eBay.

Any Problems with it? Please contact us by ebay, email or phone and we'll be very happy to help.

If for any reason you feel that you cannot leave me a Positive Good Comment Feedback with 5 Stars Detailed Seller Rating, please just contact me via eBay message form or call to above number and we will address any concerns that you may have.

RETURNS: If you decide to return your order, please contact us by eBay.

Troubleshooting

Why airbag light still ON?

You need to reset the airbag light, recommended in garage as it will not always reset automatically.

Why airbag light still ON after the reset?

1) Your car has to be diagnosed that the Seat Mat Sensor is faulty. The airbag light could be ON because of a unrelated fault codes so please check it in garage.

2) Check battery, fuses and airbag control unit if airbag light still does not reset.

The Emulator sends the same signal to the airbag control unit as original seat occupancy mat does. After installing Emulator all system works normally and the passenger airbag will always deploy in case of an accident.